



Adam Tas Corridor Energy

Must cables inside the building be placed in cable trays





Overview

Due to their exposure to the open air because of the cable trays, the wires contained within need a very durable outer covering. The regulations dictate that the cables must either be Type TC (also known as Tray Rated) or must be metal-armored (Type MC). This is a description of how to select, install, and support these metal or plastic frames, on which electrical wires are installed.



Must cables inside the building be placed in cable trays



CABLE TRAYS GENERAL INFORMATION AND

Performances of cable tray systems are dependent on its proper installation, including supports and cables. Neglecting installation and maintenance

Technical Guidelines for Cable Tray Installation and

Cable tray installation must comply with specific technical standards to ensure electrical safety, system reliability, and long-term maintainability. This document



Electrical Safety First: How Cable Trays Protect Your

4. They Give You Enhanced Fire Safety A cable tray system is typically placed close to the ceiling. This keeps the cables away from direct flames or

Cable Tray Systems: Requirements and Best Practices

This article explains the main requirements and good practices for cable tray systems, including



tray types, materials, loading, supports, bonding, cable selection, and installation details.



Types of Cable Typically Used in Cable Tray

The cable must be secured at intervals not exceeding six feet. TC cables are not permitted to be installed outside of a cable tray system or raceway with only two

Cable Tray Spacing Standards for Installation and Safety

Key Factors Impacting Cable Tray Spacing
Understanding cable tray spacing is key to meeting safety regulations and maintaining system



Best Practices for Installing Cables in Trays

Quick Installation Checklist (Key Steps) Cable tray cable installation generally follows these steps: Inspect cables before



ITER Cabling Handbook

Cable tray sections must be in accordance with the cable types and/or the number of cables installed in it, respecting the maximum filling ratio, according to the cable tray type.



Installation Of Cable In Cable Trays: NEC, Safety

Discussed are the installation in tray of single and multi-conductor insulated cables with design limitations, example calculations, equipment, and equipment usage

NEC Article 392 Guide: Ensuring Compliance for Cable

To ensure that a cable tray is safe, all the bolts should be tight, and all the connections should also be clean. Without a properly bonded tray, the tray



Installation Standards of Cable Trays

Cable trays, and the conductors and cable they contain, must be listed or labeled by a NRTL as suitable in the environment in which they are installed.



Cable Tray Questions , Cable Tray Institute

NEC section 318-5 (e) indicates that multiconductor cables rated 600 volts or less are permitted in the same cable tray, however, separation of power and control cables is necessary as indicated in other

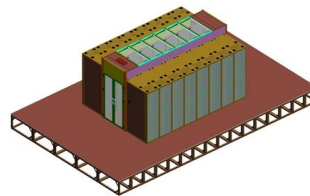

The Best Cable Management Trays for Desks in 2024

Are you tired of cable clutter and an unattractive setup? Check out the best cable management trays here.

Cable Tray Technical Guide A practical guide to product selection and

Cable tray installed in a hazardous location must contain only those cables that are appropriate for this type of environment as defined in Chapter 5 of the NEC.





100+ Essential Questions Answered About Cable Trays:

Discover over 100 expert answers about cable trays, covering key topics like material selection, load capacity, installation methods, and maintenance.

Section 27 05 36 Cable Tray for Communications Systems

3.2.1 Cable trays shall be sized (including 10% growth) as per the drawings and will accommodate all horizontal and/or backbone cabling within the Telecommunications Room as well as entering/existing

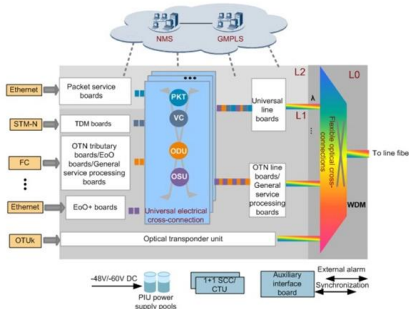

Prevent Fire and Electric Hazards When Cable Trays Used

If not designed and installed properly, wiring inside cable trays may pose hazards such as fire, electric shock, and arc-flash blast events.

Do Tray Cables Need to Be in Conduit? A Complete Guide

Tray cables (TC, TC-ER, and similar types) are specially designed for use in cable tray systems, which support multiple runs of cable across industrial and commercial buildings. Conduit,



Installation Of Cable In Cable Trays: NEC, Safety

Cable tray layout must take into consideration the design limits of the cable. To minimize damage and verify integrity after installation, follow the practices



Annex I

When cable trays have to connect two buildings and have to go through accessible trenches, the minimum size of the trenches must allow human access along the cable trays placed in these

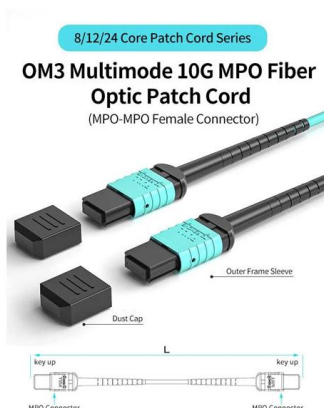
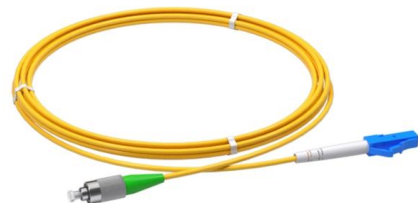

Installing Class 2 and power cables in cable trays.

(1) In Cables, Compartments, Cable Trays, Enclosures, Manholes, Outlet Boxes, Device Boxes, and Raceways. Conductors of Class 2 and Class 3 circuits shall not be placed in any cable, cable tray,



Cable Tray Questions , Cable Tray Institute

Question 1: Can mechanical utility piping or tubing containing water or compressed air be installed in cable trays with electrical cables?
Answer: No. Cable trays are a support system for electrical cables,



Cable Tray SHIB NAL

Cable trays are not raceways, but they are treated as a structural component of a facility's electrical system. Cable trays are a part of a planned cable management system to support, route, protect and

Cable Tray Technical Guide A practical guide to product selection and

SOLID-BOTTOM CABLE TRAY Providing additional cable protection, solid-bottom cable tray is sometimes preferred to support and protect numerous small instrumentation and control cables.



Method Statement for Instrumentation Cable Termination

Step-by-step method statement for instrumentation cable termination. Covers NEC, NFPA, SAES standards, tools, safety, grounding, and QA/QC.

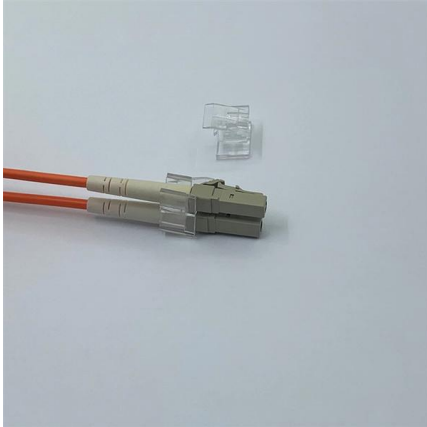

Cable Tray Systems: Requirements and Best Practices

Comprehensive guide to cable tray systems requirements: tray types, materials, loading, supports, bonding, routing, and best practices for safe electrical cable management.



1075KW HH ESS

Contact Us

For datasheets, pricing, or custom telecom energy solutions, please visit:
<https://www.koskolong.co.za>