



Adam Tas Corridor Energy

Standard configuration of household electrical distribution boxes and wiring ducts





Overview

This guide covers split load vs dual RCD vs RCBO board configurations, circuit arrangement and allocation, BS 7671 labelling requirements, type testing under BS EN 61439, SPD installation, wiring best practice, and the common mistakes found during EICR inspections. In a typical home installation, the consumer unit (also called a distribution board) is the heart of the system: it distributes power to every circuit and, more importantly, it coordinates the protections that keep people, wiring and appliances safe. But these standards are general, applicable to all types of premises, and do not provide simplified and. Choose the right box based on environment (indoor/outdoor), load capacity, and durability. Electrical wiring powers everything in your home, from lights and outlets to major appliances. Whether you're building new or updating an older system, the way your wiring is planned and installed affects how safely and efficiently everything runs.



Standard configuration of household electrical distribution boxes and



CHAPTER 6 GUIDELINES ON DESIGN OF ELECTRICAL

It is the responsibility of the customer's REC/REW to ensure that design of the electrical installation complies with HK Electric Supply Rules, the latest edition of Code of Practice for the Electricity

Understanding Distribution Boxes: A Comprehensive Guide

A distribution box, also known as a power distribution box or electrical distribution box, is used to distribute electrical power safely to multiple



Home Electrical Wiring Basics: Components, Types, and

Learn the basics of home electrical wiring including wire types, gauges, safety practices, and key components used in residential electrical systems.

Size determination, installation method and wiring mode

The distribution box is the central hub of the home circuit and the general control of our daily



power consumption. It is an indispensable electrical equipment. If there



Home Electrical Panel: Complete Guide & Diagrams , Solera

Complete guide to the home electrical panel: components, wiring diagrams, and regulations. Learn how to understand your fuse box.

From the Ground Up: Electrical Wiring

We'll break down the key parts of a home electrical system, including layout, materials, and safety considerations, along with practical tips to help you



Understanding Your Home Electrical System

Electrical Service Panel Home Wiring System Electrical Outlets and Receptacles Extension Cords Introduction Electricity plays an essential role in how your home operates. Whether watching TV,



Distribution Box and Selection Guide

The nature of your property plays a crucial role in determining the appropriate Distribution Box. Different settings have distinct electrical

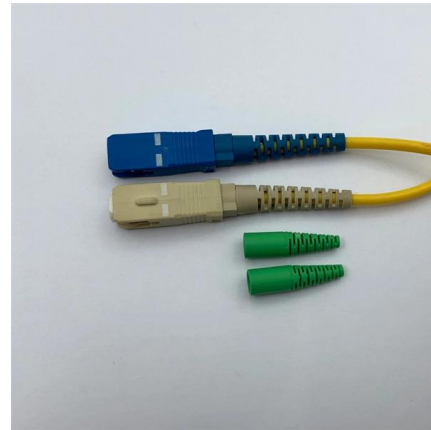

Home Wiring Guide

The consumer unit or commonly known as fuse box is the heart of a home wiring installation. It is usually mounted near the energy meter. A modern consumer unit

How to Wire Single-Phase Consumer Unit with RCD?

In this tutorial, we will be showing how to wire a single phase consumer unit for 230V with and without RCD's according to IEC. We will be using the IEC wiring color



Choosing Electrical Boxes

Double-gang boxes hold two devices; triple-gang boxes hold three devices. Remember: Everything that takes up space in a box must fit without

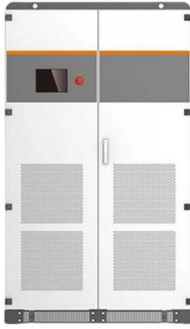

Electrical Wiring, House Wiring or Home Wiring

Single Phase wiring installation is the most common wiring in our homes and residential buildings. The Single Phase supply is 220Vac supply,



Electrical wiring

Electrical wiring is an electrical installation of cabling and associated devices such as switches, distribution boards, sockets, and light fittings in a structure.

The Ultimate Guide to Wiring Ducts for Neat and Efficient

Narrow Slot Wiring Ducts: Designed for high-density wiring applications, narrow slot wiring ducts offer a space-efficient solution while still providing effective wire organization. Conclusion: In the intricate

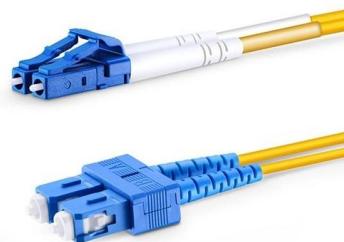



Specification 034. Electrical Installations

4. This update includes modifications taking account of the 16th Edition of the Wiring Regulations, now British Standard (BS) 7671:2001 Amendment No. 1, 2002 (AMD 13628) and the IEE

Visualizing Your House's Wiring Path: A Comprehensive

Discover the essential elements of a house wiring piping diagram and learn how to create one for your home electrical system.



Underground Residential Distribution Layouts

Distribution Layouts Distribution circuits to residential areas are similar to overhead designs, except the installation is underground. Primary mains, with take-offs, are installed to which are connected the

The installation requirements for the distribution box

Learn how to install a distribution box safely and correctly. Covers wiring, placement, standards, and expert tips for a compliant setup.





Motor protection controller



technical guidance for developers domestic electricity

All boxes are to be installed by you prior to our operatives attending site for the service connection ensuring doors are fitted. Ducts are to be individually ducted and cannot share a duct. The correct

GUIDELINES FOR ELECTRICAL WIRING IN RESIDENTIAL

The Guidelines will also be useful for owners of residential buildings or wiring installations to recognise the requirements of safe and adequate electrical wiring. It is hoped that the Guidelines will ensure



Distribution boards components

Service cable ducts or conduits, surface mounted or in cable chases embedded in the wall Note: to facilitate future modifications to the installation, it is recommended to keep all relevant

Residential electrical installation

Therefore, the content of this section is an overview of the main requirements or recommendations for residential premises, from an international point of view, based on some



From the Ground Up: Electrical Wiring

Read our guide to electrical wiring, covering layout, materials, safety, and planning for a safe, efficient home system.



Residential Duct Systems for New and Retrofit Homes Design and

Why it is important to properly design and install high quality, efficient ducted air systems ? "The efficiency of air distribution systems has been found to be 60-75% or less in many houses because of

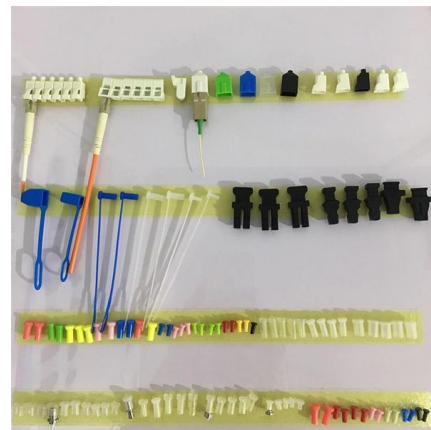

Component Diagram



Key dimensions

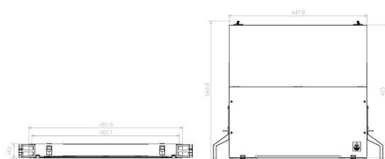

GENERAL SPECIFICATION FOR ELECTRICAL INSTALLATION IN

The materials contained in this document may not be pertinent or fully cover the extent of the installation in non-government buildings and there is no intimated or implied endorsement of the sales, supply



Distribution Board Wiring Guide , Consumer Unit Layout

A distribution board (commonly called a consumer unit in domestic installations) is the central point where the incoming electrical supply is split into individual circuits that serve different

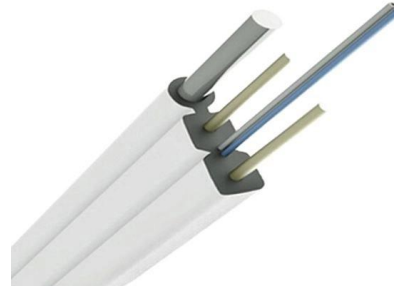

Standard residential electrical wiring: Crucial 2025 Guide , Sartell

Understanding how standard residential electrical wiring works starts with knowing these essential building blocks that work together to keep your lights on and appliances running.

A Step-by-Step Guide to Wiring an Electrical Panel Box

A Step-by-Step Guide to Wiring an Electrical Panel Box An electrical panel box, also known as a breaker box or a distribution board, is a crucial component of any



The installation requirements for the distribution box

Learn how to install a distribution box safely and correctly. Covers wiring, placement, standards, and expert tips for a compliant setup. A distribution



Contact Us

For datasheets, pricing, or custom telecom energy solutions, please visit:
<https://www.koskolong.co.za>