



Adam Tas Corridor Energy

What equipment is included in a core switch





What equipment is included in a core switch

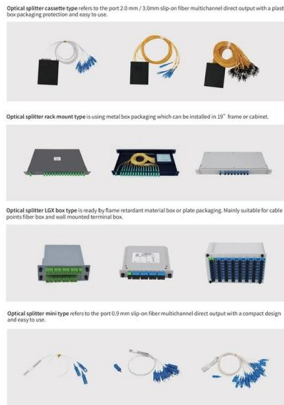

What Is a Core Switch?

Enables IP routing between VLANs, subnets, and security zones, with advanced routing protocols. Includes dual power supplies, hot-swappable modules, link aggregation (LAG), and support for

Core Switch: The Powerhouse of Your Network

What is a core switch and how does it differ from other switches? Defining the Core Switch and Its Role in Network Architecture The core switch is



What Is a Core Switch? Network Backbone Architecture Guide

Consequently, core switches are engineered with extreme redundancy at both the physical and logical levels. Physically, they feature hot-swappable dual power supply units (PSUs)

Network Switch Components and Technical Analysis

A Network Switch is one of the essential devices for building modern networks, capable of



enhancing network performance and reliability, providing stable and efficient data transmission services for

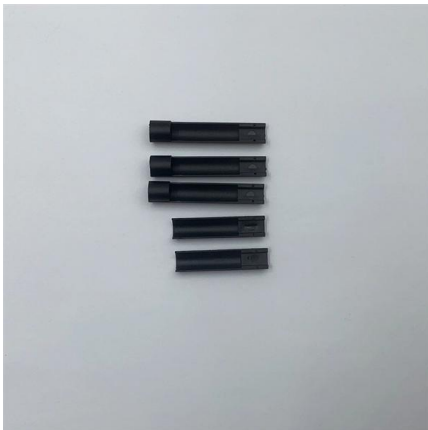

Core Switch Explained: Key Functions and Benefits

Look for core switches that have features like hot-swappable cooling fans and redundant power supplies. These can reduce downtime for repairs and save money over time.

What is a Core Switch?

What is a Core Switch? A Deep Dive A core switch is the backbone of a network, providing high-speed switching for data packets between different network segments; essentially, it's



FS Community

Hier sollte eine Beschreibung angezeigt werden, diese Seite lässt dies jedoch nicht zu.



What is a Core Switch , Functions and Difference over Normal Switch

It is a powerful backbone switch in the center of the network core layer, which centralizes multiple aggregation switches to the core and implements LAN routing.



Core switch definition - Glossary , NordVPN

A core switch is the primary switch in a network, built to transfer data fast. A core switch sits at the top of a network's structure.



Core Switch

Definition of Core Switch A core switch is a high-capacity, central networking device that serves as the backbone of a computer network, facilitating



What Is Core Switch?

A core switch is the high-capacity networking switch that forms the backbone of a network, directing data traffic between different network segments and ensuring efficient



What Is a Core Switch in Networking?

Key components include: Switching Fabric: The italic heart of the switch, responsible for forwarding data packets between ports. Routing Engine:



What is a Core Switch?

A core switch is a crucial component of a network infrastructure that serves as the backbone of a network. It's a high-performance switch that provides high-speed

Core Switch vs Access Switch , Definitions and Key Differences

The core switch is the backbone of your network. It's the most important piece of equipment because it connects all your other switches and routes traffic between them. The access





Understanding the Core Switch: Key Differences and Uses

A: A core switch does in a high-capacity core network infrastructure by providing wide-scale interconnect for data, abundant bandwidth resources,

What is a Core Switch?

Spread the loveA core switch is a crucial component of a network infrastructure that serves as the backbone of a network. It's a high-performance switch that provides

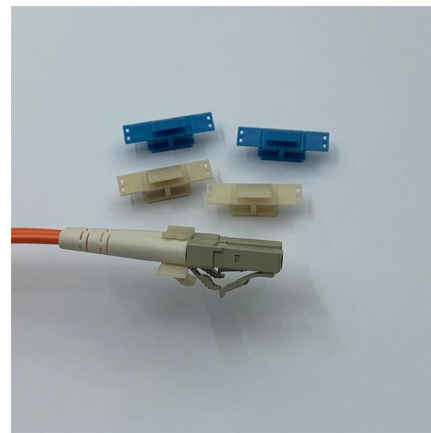

Core Switch vs. Distribution Switch vs. Access Switch

What is a Core Switch? A core switch is the primary switch installed at the backbone of a layered or hierarchical network. These data switches are responsible for

Core Switch vs Access Switch , Definitions and Key Differences

The core switch is the backbone of your network. It's the most important piece of equipment because it connects all your other switches and routes traffic between them. The access switch, on the other



Core Switch

Core switches are defined as high-capacity switches located at the top of a cloud data center network, connecting aggregation switches and providing interfaces to wide area networks (WANs). They are



Core Switch

Core switches are defined as high-capacity switches located at the top of a cloud data center network, connecting aggregation switches and providing interfaces to wide area networks (WANs).



An Extensive Library of Self-Developed Products



Core Switches: The Pillar of Network Infrastructure

Get a closer look at core switches: the nerve centers of network infrastructure that enhance performance and facilitate growth.



Basic Understanding of Core Switch

Core switch is designed to meet the most demanding enterprise network requirements such as reliability, high speed, and scalable. It supports the



What Is the Core Switch?

The core switch is the central, high-capacity switching point within a network, responsible for forwarding data between different parts of the network and often connecting to multiple

Access Switch vs. Core Switch

Access Switch vs. Core Switch What's the Difference? Access switches are typically used to connect end devices such as computers, printers, and IP phones to the network. They are responsible for

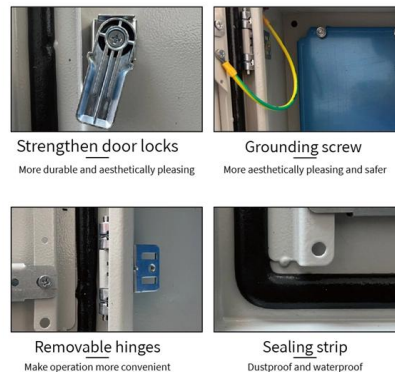

What Is a Core Switch in a Network?

To ensure the network remains operational during component failure, core switches are built with significant hardware redundancy. This includes features such as dual, hot-swappable



Contact Us

For datasheets, pricing, or custom telecom energy solutions, please visit:
<https://www.koskolong.co.za>