



Adam Tas Corridor Energy

What is a cable tray that is not a fixed bridge called





Overview

A channel cable tray is a compact, single-piece tray system with a narrow base and raised side flanges. Unlike ladder or trough trays, channel trays are designed to support small cable quantities over short distances. Each cable tray type performs a different function and comes in various materials such as aluminum. Whether you're running power cables, data lines, or control wiring, the right choice between cable trays, baskets, ladders, and trunking can save time, reduce maintenance, and extend system life. Understanding the Four Main Cable Containment Systems Cable trays are solid or perforated metal.



What is a cable tray that is not a fixed bridge called



What Is A Cable Tray? 5 Types Of Cable Trays

A cable tray is a structural system used to support and manage electrical cables in various settings, such as industrial, commercial, and residential environments.

The Comprehensive Guide to Cable Tray Systems:

A cable tray system is a metallic bridge that securely contains electrical wires. It has cables organized, cool, and off the ground. In the case of



Cable Tray vs Cable Basket vs Cable Ladder vs Cable

Compare cable tray, basket, ladder & trunking systems. Learn the pros, cons, and best uses for each type, with links to our UK product ranges.

Exploring Cable Tray Types and Applications

Often unheralded, cable trays play a vital role in tray cable installations throughout industrial, commercial, and residential projects.



Cable Tray Types and Sizes

The wire mesh cable tray, also known as a basket cable tray, is constructed using welded steel wires that form a mesh-like, open structure. This design is especially

The difference between tray type cable tray and trough type bridge tray

Non-hole cable slot tray: the trough cable tray is a fully closed bridge tray, and its appearance design is the same as that of a closed box. Because of its sealed characteristics, its anti-interference effect is

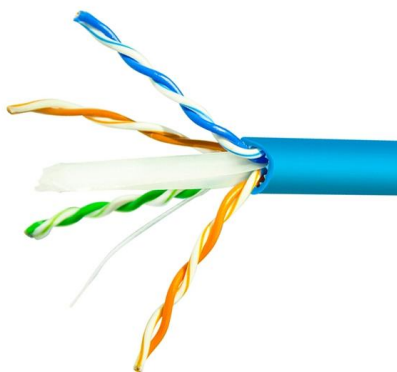
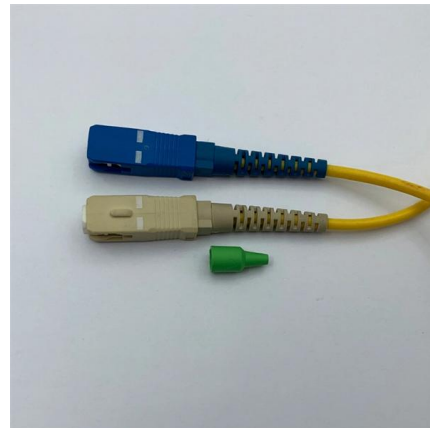

Types of Cable Trays: Ladder, Perforated, Basket, Solid

Basket cable trays are welded wire structures that support electrical cables in an orderly manner, especially control and data cables.



Cable Tray Today: An overview , Cable Tray Institute

The face of cable tray is changing to meet today's market needs. A few short years ago, cable tray was a "smoke stack" product, used primarily in heavy industrial facilities to support power cables. Today it



What are Cable Trays & Different Types of Cable Trays

Learn what cable trays are & explore the various types, benefits, and purposes. Gain insights into how electrical cable trays can revolutionize your

7 Types of Cable Trays: How to Choose the Right One

A channel cable tray is a compact, single-piece tray system with a narrow base and raised side flanges. Unlike ladder or trough trays, channel trays



What are the main types of cable tray?

Introduce the main types of cable tray including ladder cable tray, perforated cable tray, solid bottom cable tray and wire mesh cable tray.



What is a cable tray?

A cable tray is a support system that creates a rigid structure for wires and cables to travel along. An alternative to open wiring or electrical conduit



Types of Cable Trays

Channel cable trays are also known as trough cable trays and sport a narrow, U-shaped design that may have either a perforated or a solid bottom.

Cable Trays and Their Uses: Definition, Types, and

Learn about cable trays for desks, accessories, and how they compare with raceways, conduits, and trunking for efficient cable management.



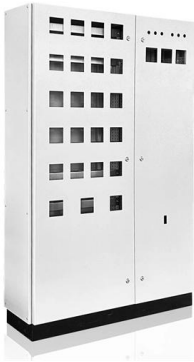

What are the 5 basic cable tray types?

Cable trays are an essential component in electrical installations, providing a safe, efficient, and organized way to support and route cables. Understanding the different types of cable trays is crucial

Types of Cable Trays - Purpose, Advantages,

Cable tray is alternatives to wire ways and electrical conduits, which completely enclose cables. Study types of cable trays, purpose, advantages.



Difference Between a Cable Ladder and Cable Tray

What is a Cable Ladder? A cable ladder, also known as a ladder cable tray, is a support system that consists of two longitudinal side rails connected by individual

Types of Cable Trays - Purpose, Advantages,

Cable tray systems are alternatives to wire ways and electrical conduit, which completely enclose cables. Cable trays are capable of supporting all types of



Cable Tray vs. Wireway: Which Offers the Best Cable Protection?

A cable tray is a support system used to hold cables in place, typically used in industrial settings. It consists of a series of

What Is a Cable Tray? Types, Designs, and Advantages

What is a Cable Tray A cable tray is a mechanical support system that forms a rigid structure for insulated electrical conductors, including high-voltage power lines, control cables, and fiber optics.



Types of Cable Trays - Advantages, Applications and Sizes

Ladder trays have open rungs for excellent ventilation and easy cable access, while perforated trays have a base with holes that provide moderate ventilation and support for smaller



Cable tray

A solid-bottom tray provides the maximum protection to cables, but requires cutting the tray or using fittings to enter or exit cables. A deep, solid enclosure for cables

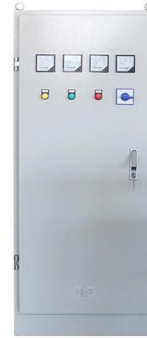

Cable Tray Systems: A Complete Guide to Types

A cable tray system is a unit assembly of sections and fittings that forms a rigid structural system used to securely fasten or support cables and

7 Types of Cable Trays: How to Choose the Right One

Cable tray systems are engineered support structures designed to route, support, and protect insulated electrical cables used for power distribution,



CableHero

Cable trays act as bridges, allowing safe transportation of wires and protecting them from overheating. Understanding the different types of cable trays helps in



Component Diagram

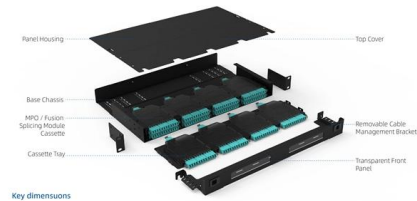

Key dimensions

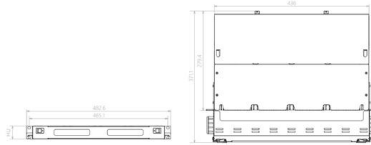

Cable Tray vs Cable Basket vs Cable Ladder vs Cable

Also known as wire mesh trays, these are lightweight, flexible, and perfect for routing small cables or network wiring. Their open structure gives maximum airflow and

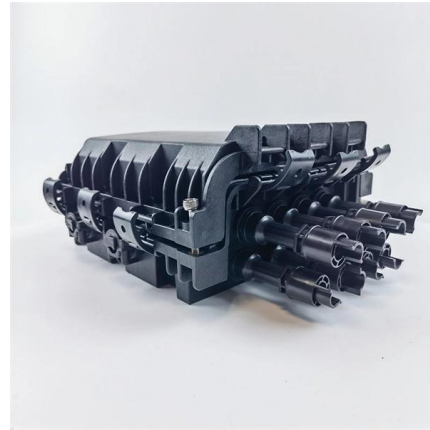

Contact Us

For datasheets, pricing, or custom telecom energy solutions, please visit:
<https://www.koskolong.co.za>