



Adam Tas Corridor Energy

What is an indoor power distribution box controller





Overview

A power distribution box works like a traffic controller for electricity. It takes in power from the main supply and sends it out to different areas or devices through separate circuits. Key components include circuit breakers, fuses, bus bars, and internal wiring for safety and.



What is an indoor power distribution box controller

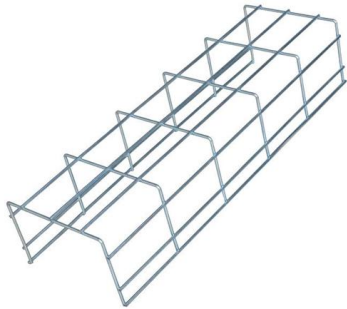

The Ultimate Guide to Distribution Box Types

Discover the key types of distribution boxes with NUOMAK's comprehensive guide. Learn about Main Distribution Boards (MDB), Consumer Units, Transfer

how does a power distribution box work

The distribution box is a very important component of the power system. It is responsible for transmitting electrical energy from the power station



Power Distribution Box Essentials: Functions, Types

7) Considerations for choosing a power distribution box The context, security needs, and purpose all play a vital role in deciding a power distribution

Distribution Box vs Control Box vs Junction Box: Key

Learn the differences between distribution boxes, control boxes, and junction boxes.



Discover their functions, applications, and how E-abel provides



Power Distribution vs. Control Cabinets: What's the

Learn the key differences between power distribution and control cabinets. Explore functions, design considerations, standards, and applications in



Distribution Box Guide: Types, Components & Solutions

Understand distribution boxes (DB boxes) in 5 minutes. Learn about types, components, functions, and uses. Find the perfect DB box for your needs.



What Is an Electrical Distribution Box and Why Is It

An electrical distribution box distributes power safely, prevents overloads, and protects circuits, ensuring efficient and reliable electrical systems.



What Is The Internal Structure Of The Power Distribution

What is the internal structure of the power distribution box and distribution cabinet? The most detailed explanation, learning collection essential!



What Is an Electrical Distribution Box? A Complete Guide

The electrical distribution box serves a critical role in the safe distribution of power by centralizing circuit control and preventing overloads and short circuits. Its design

Power Distribution Boxes Explained Simply

A power distribution box works like a traffic controller for electricity. It takes in power from the main supply and sends it out to different areas or devices through separate circuits.



Explore Power Distribution Box Types and Functions

It integrates power distribution, protection, and monitoring capabilities, and is responsible for distributing power to entire commercial or residential



Power Distribution Boxes Explained Simply

A power distribution box acts like a traffic controller for electricity. It receives power from the main supply and routes it to different devices or areas

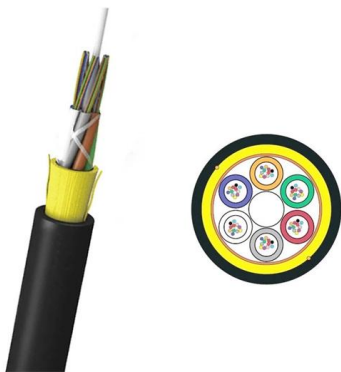
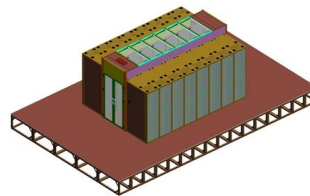

What is a power distribution box?

Sometimes referred to as a power distribution unit ('PDU') or simply a distro, a power distribution box is used to safely distribute electricity from the power source to other devices in a circuit. It typically has

Understanding Distribution Boxes: A Comprehensive Guide

Learn what a distribution box is, its types, and how to choose the right one for your project. Includes clear examples and expert tips.



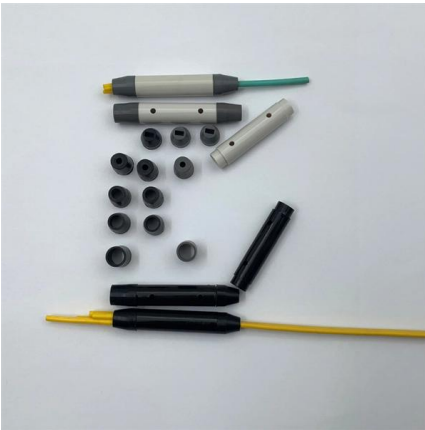

ITPro Today, Network Computing, IoT World Today combine

ITPro Today, Network Computing and IoT World Today have combined with TechTarget . The page you are looking for may no longer exist.

What Is a Control Box? Functions, Types & Uses

Discover what a control box is, how it works, key components, types, and design tips for industrial, commercial, and residential use.



Distribution Box Guide: Types, Components & Solutions

These smart boxes, often combined with devices like PDU power distribution units, can remotely control lighting, heating, and appliances via

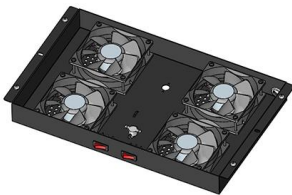

Distribution Boxes: Types and Functions

A distribution boxes acts as the load center and main distributor of electrical power within a building. Also called a distribution board, panel board,



Intelligent Power Distribution Box Solution

Intelligent power distribution box is composed of traditional leakage protector, air switch, AC contactor and KC868-H8. Compared with the traditional power



What is a Distribution Box? - A Comprehensive Guide

So, what is a distribution box? It organizes and controls power flow, ensuring safety and efficiency. By managing circuits individually, it prevents



Understanding Distribution Boxes:A Comprehensive Guide

A distribution boxes is an essential device that manages the safe and efficient flow of electrical power throughout different areas of a building or facility.



Distribution Box vs Control Box vs Junction Box: Key Differences and

It does not control or distribute power in the same way as distribution or control boxes. Instead, its main role is to facilitate safe cable connections and branching.



Ultimate Guide To Distribution Boxes Db Boxes Types

This ultimate guide explains what a distribution box does, its internal components, common types, real-world applications, and how to select the right DB Box for



What is an Electrical Distribution Box? A

An electrical distribution box is often called the control hub of a building's electrical system, and for good reason. It's where power from the main





Contact Us

For datasheets, pricing, or custom telecom energy solutions, please visit:
<https://www.koskolong.co.za>